

# TUNE-O-MATIC SADDLE INSTALLATION INSTRUCTIONS

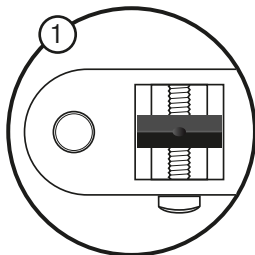

STEP 1 . Once you have removed the old saddles and replaced them with your new Graph Tech saddles, set the intonation "starting point": screw the intonation screw so that the saddles are close to the centre of the bridge. Tune your guitar to concert pitch.

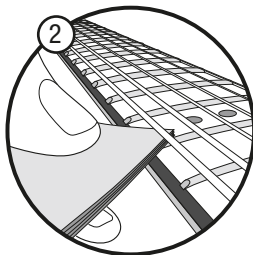

STEP 2 . To determine correct string height, measure the gap between the top of the twelfth fret and the bottom of the low E string. It should be around 3mm/.118", or about a stack of 12 business cards if you don't have a ruler. For the high E string, the gap should be around 2mm/.079", or about a stack of 8 business cards.

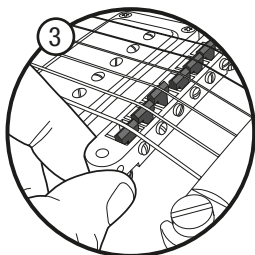

STEP 3 . To adjust your string height, adjust the two thumb wheel screws up or down until correct string height is achieved. Tune guitar to concert pitch after each adjustment.

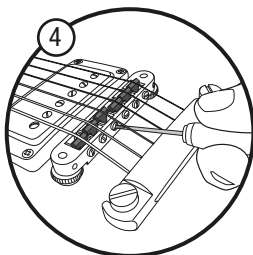

STEP 4 . The fretted 12th position of a string should match its 12th fret harmonic (lightly touch the string right above the 12th fret and pluck). Adjust the intonation screw with a screwdriver. Shortening the distance between the saddle and nut will increase the pitch of the harmonic; increasing the distance lower the pitch. Retune to concert pitch after each adjustment. Repeat for each string.